

SCHEMA GEOMETRICA PILA NR. 1
scara 1:50

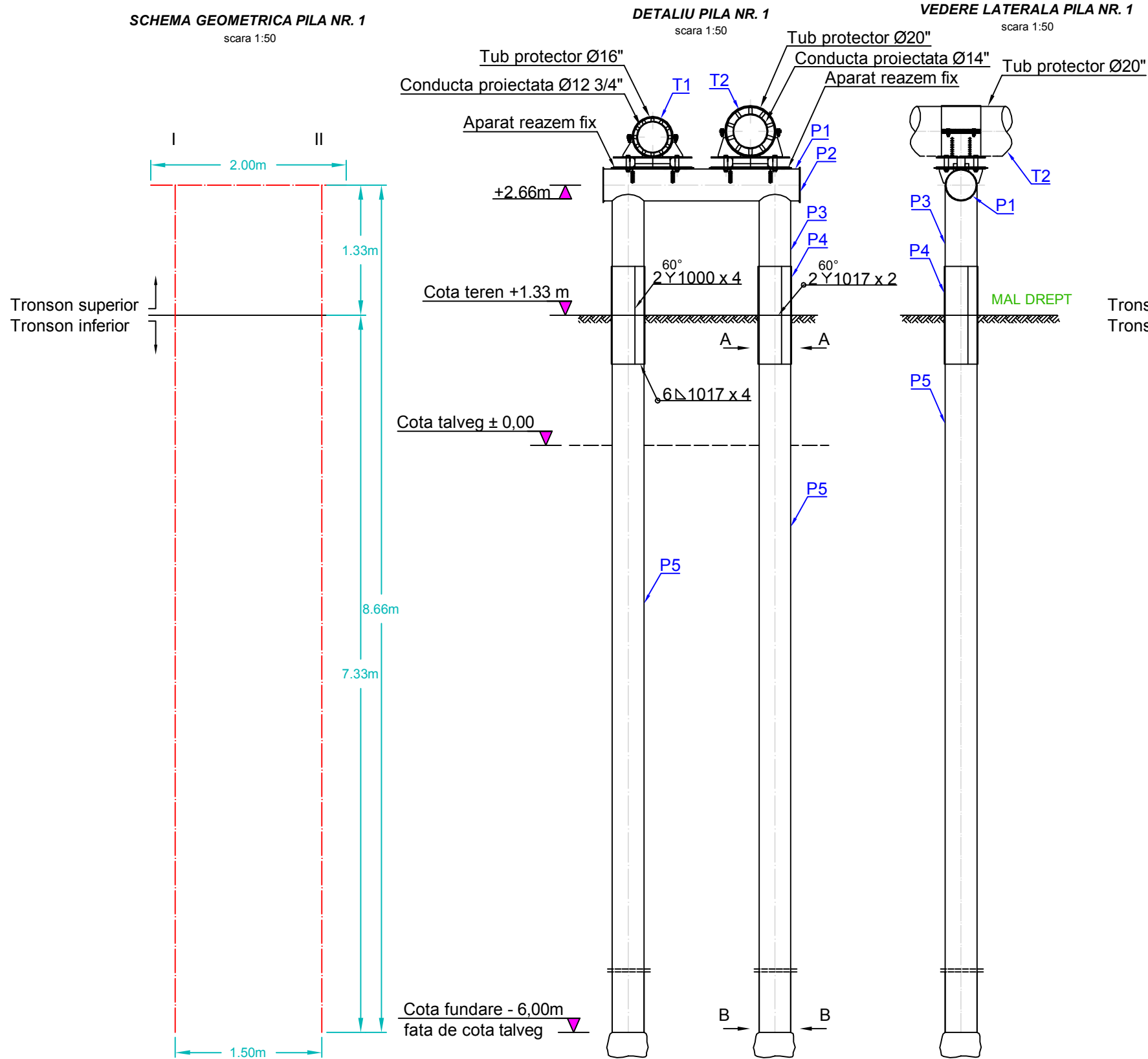

DETALIU PILA NR. 1
scara 1:50

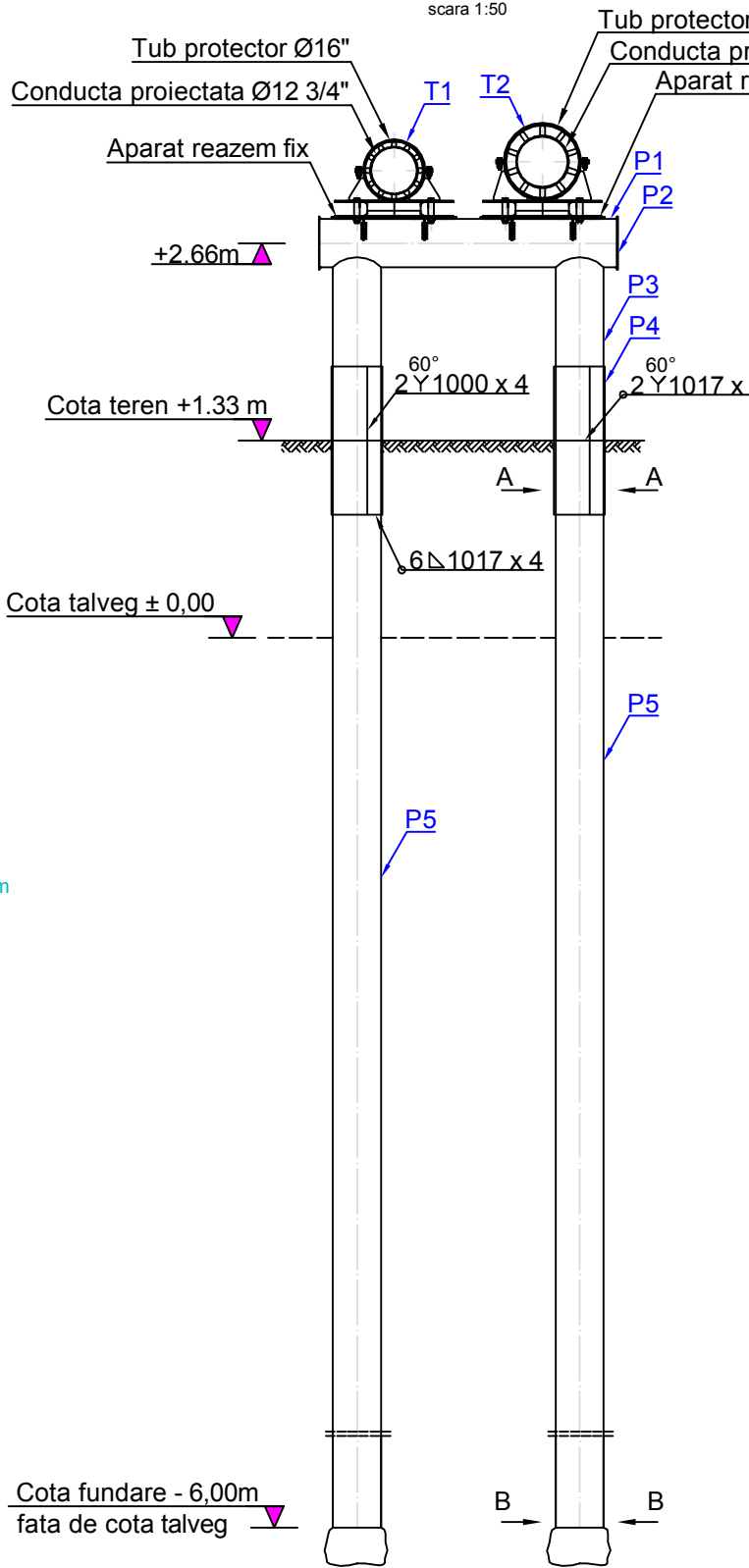

VEDERE LATERALA PILA NR. 1
scara 1:50

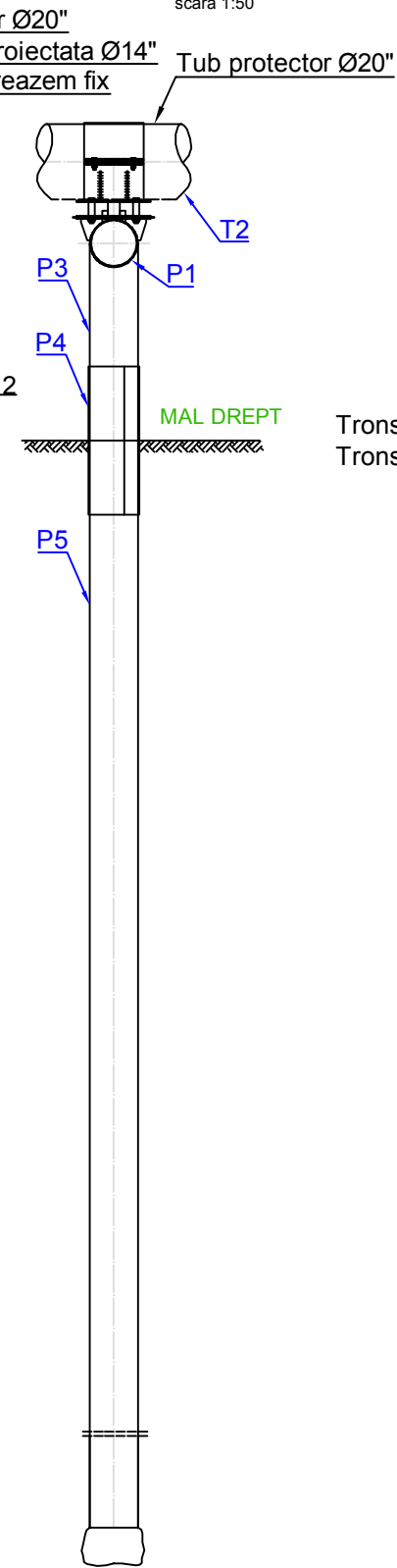

SCHEMA GEOMETRICA PILA NR. 2
scara 1:50

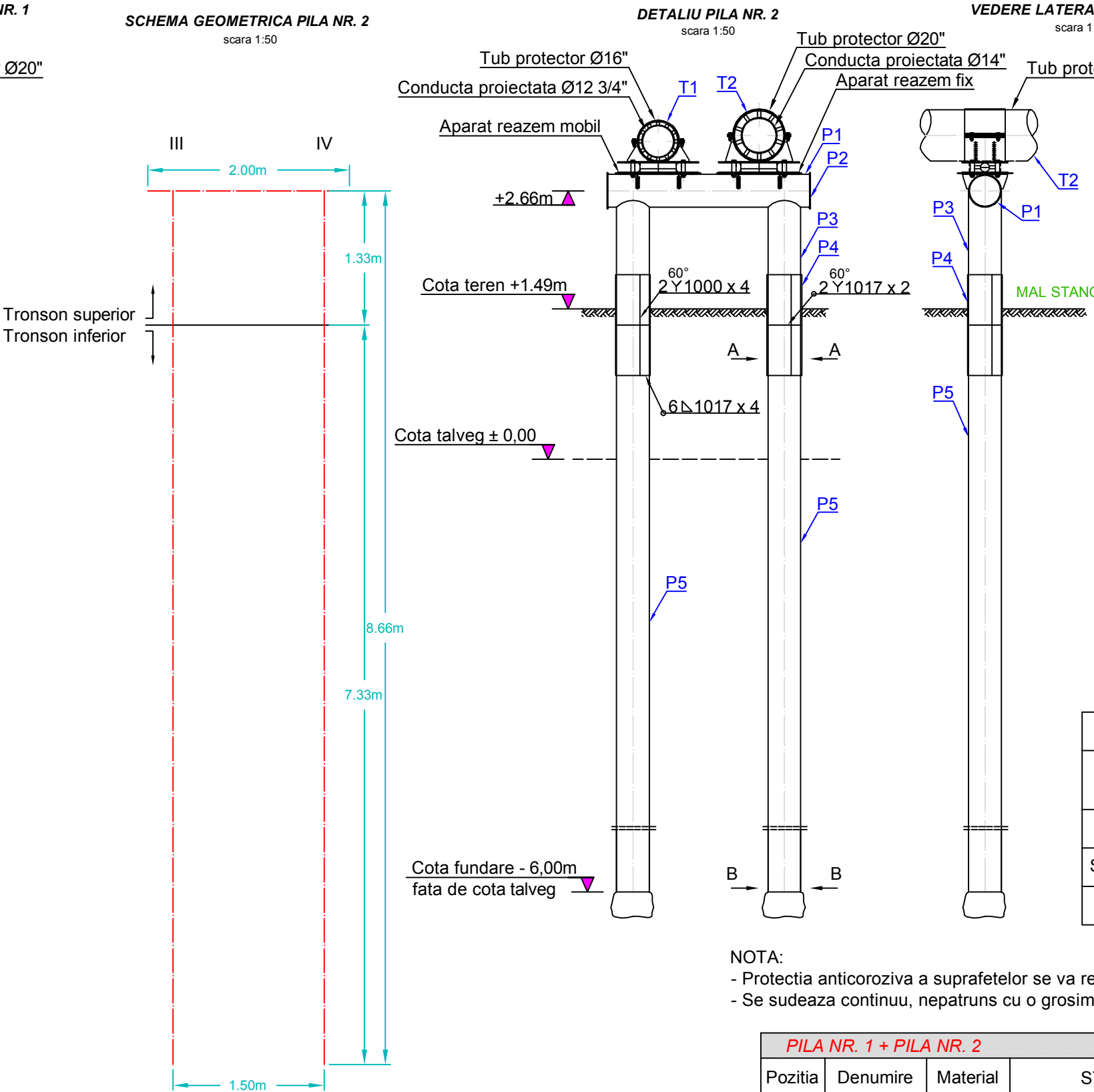

DETALIU PILA NR. 2
scara 1:50

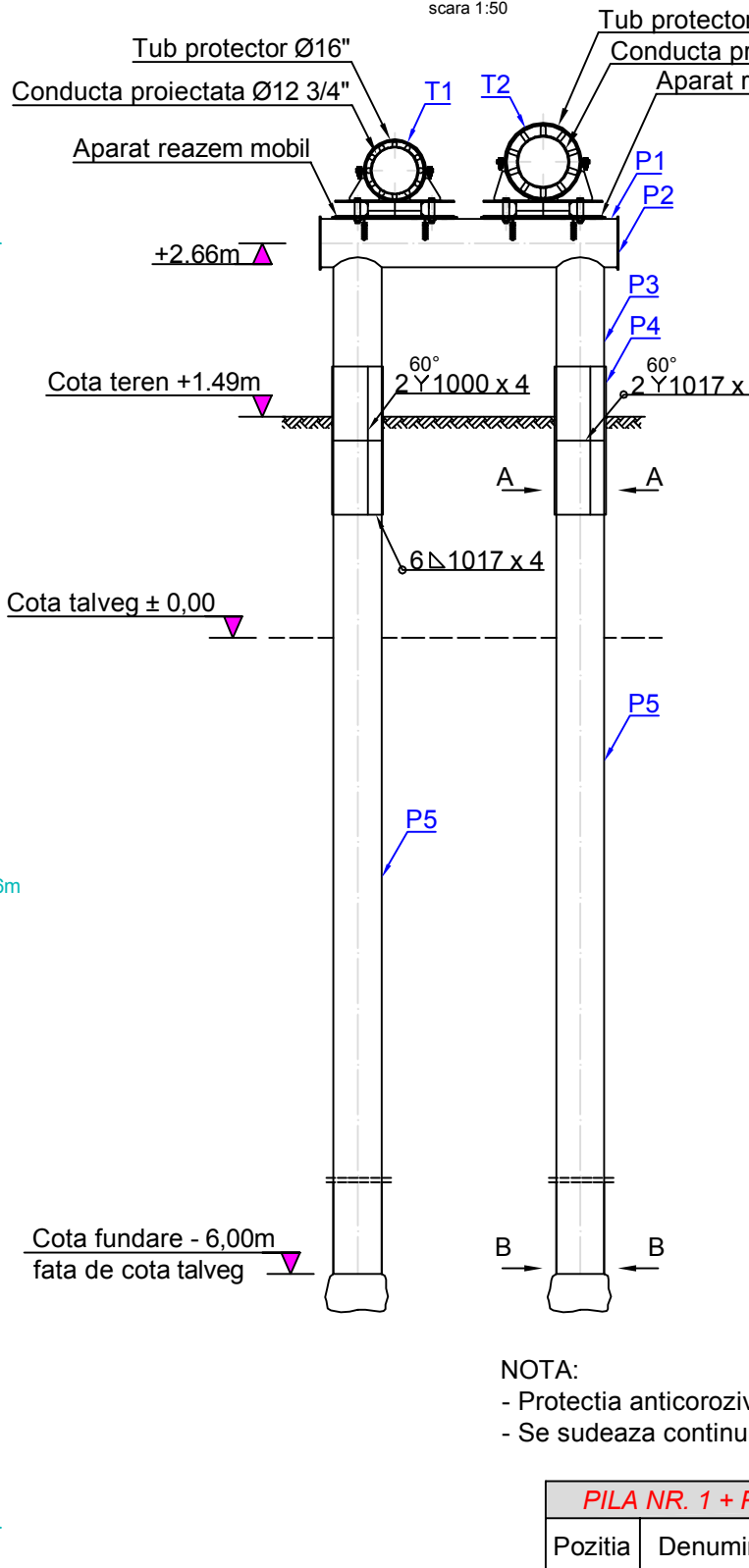

VEDERE LATERALA PILA NR. 2
scara 1:50

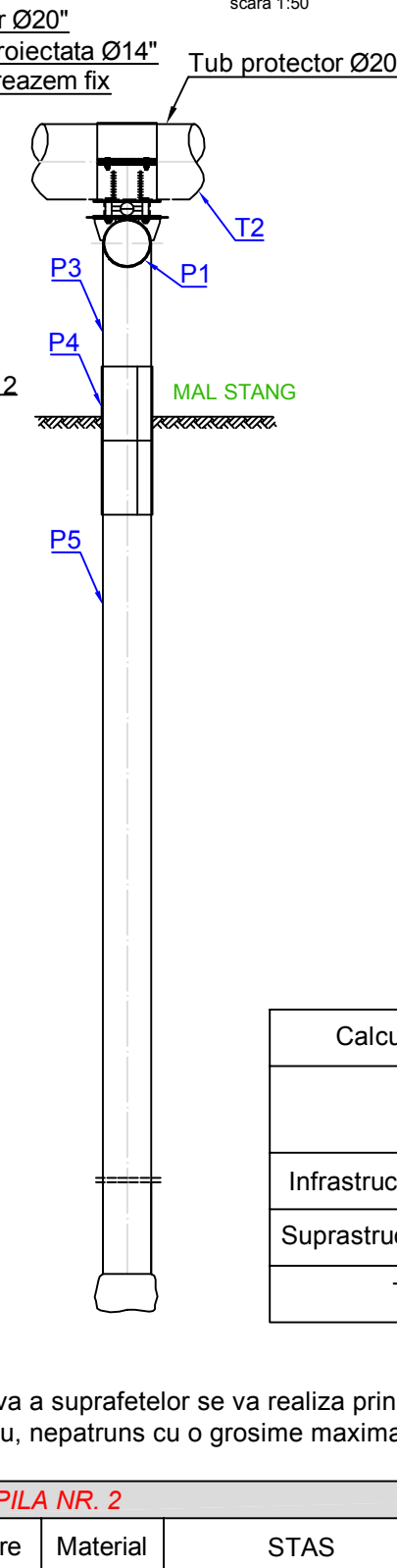

Calcul volum beton pompabil C18/22,5 - teava Ø323.9 x 8mm					
	Volum / ml pilot [mc]	Lungime pilot [m]	Nr. piloti / pila	Nr. pile	Total volum beton [mc]
Infrastructura	0.196	7.33	2	2	5.75
Suprastructura	0.082	1.33	2	2	0.44
TOTAL [mc]					6.18

NOTA:
- Protectia anticoroziva a suprafetelor se va realiza prin grunduire si vopsire in 2 straturi de vopsea pe baza de ulei.
- Se sudeaza continuu, nepatruns cu o grosime maxima a cordonului de sudura de 0.7 din grosimea minima a pieselor imbinate.

PILA NR. 1 + PILA NR. 2										
Pozitia	Denumire	Material	STAS	Dim. [mm]		Kg/ml	Lungime/ buc [m]	Kg/buc	Nr. buc	Masa [K]
P1	Dn 300	L360N	SR EN ISO 3183/2013	323.9 x 8.8		68.40	2.00	136.80	2	273.60
P2	Tb. 8	S235JR	SR EN 10029:2011	340 x 340 x 8		-	-	7.26	4	29.04
P3	Dn 300	L360N	SR EN ISO 3183/2013	323.9 x 8.8		68.40	1.33	90.97	4	363.89
P4	Tb. 8	S235JR	SR 6898-1:95	340 x 1000		32.75	1.00	32.75	8	262.00
P5	Dn 300	L360N	SR EN ISO 3183/2013	323.9 x 8.8		68.40	7.33	501.37	4	2005.41
SUDURA 3% [Kg]										88.02
MASA [Kg]										3022.01

Pozitia	Denumire	Material	STAS	Dim. [mm]	Lungime otel/ml [m]	Kg/ml	Lungime/ pilot [m]	Nr. piloti/pila	Nr. pile	Masa [K]
P6	Otel rotund	PC 52	SR EN 10060:2004	Ø16 mm	8	1.578	8.66	2.00	2	437.30
P7	Otel rotund	OB 37	SR EN 10060:2004	Ø6mm	6.69	0.222	8.66	2.00	2	51.45
P8	Otel rotund	OB 37	SR EN 10060:2004	Ø6mm	0.43	0.222	8.66	2.00	2	3.31

MASA ARMATURA [Kg]										492.05
MASA TOTALA [Kg]										3514.01

TUBURI PROTECTOARE										
Pozitia	Denumire	Material	STAS	Dim. [mm]		Kg/ml	Lungime totala [m]	Kg	Nr. buc	Masa [K]
T1	Dn 400	L360N	SR EN ISO 3183/2013	406.4 x 8.0		78.60	13.00	1021.80	1	1021.80
T2	Dn 500	L360N	SR EN ISO 3183/2013	508 x 8.0		98.60	13.00	1281.80	1	1281.80
MASA TOTALA TUBURI [Kg]										2303.60

Verificator/ Expert	Nume	Semnatura	Cerinta	Referat / Expertiza Nr. / Data	
S.C. SNIF PROIECT S.A. Targoviste Numar de inmatriculare J15/925/2005			Beneficiar: CONPET S.A. PLOIESTI		Pr. nr. 309
Specificatie	Nume	Semnatura	1:50 1:10	Inlocuire conducta de transport tip 1012 si 1014 - Cănojan-Ploiesti in zonele: Crivat-Catunu pe o lungime de cca. 550m+30m foraj orizontal subtraversare DN 1A Bucuresti-Ploiesti, loc. Ghimpati - traversare rau Colentina pe o lungime de cca. 500m si loc. Sfântu Gheorghe - Crevedia Mica, pe o lungime de cca. 1.100m, cu un total de 2.180m pe fir	Faza PT+CS+D
Sef proiect	Ing. Costea Paul				
Desenat	Ing. Radu Florin		Data: 2015		
Sef proiect	Ing. Costea Paul				DETALII PILE SUSTINERE

P4 - 8mm
scara 1:10

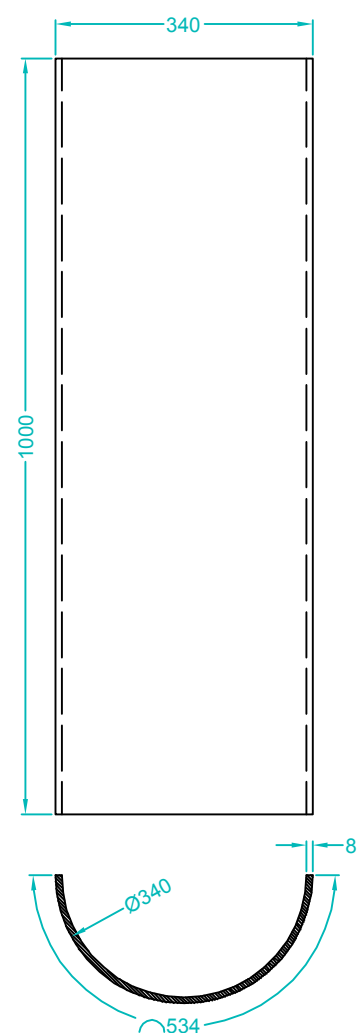

SECTIUNEA A - A
scara 1:10

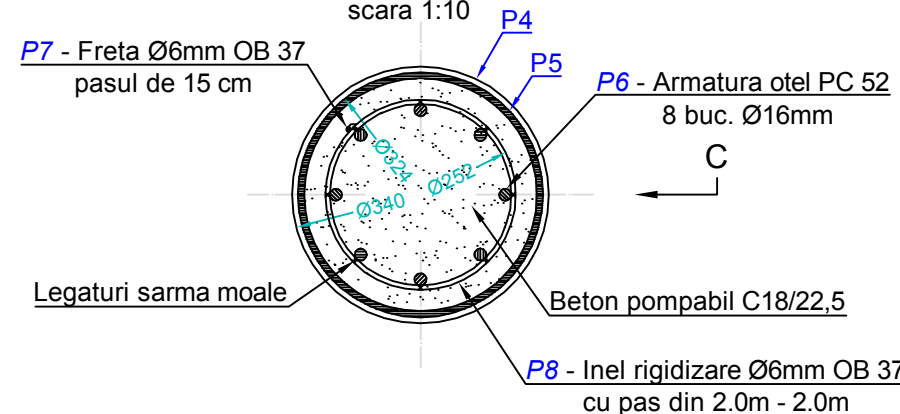

SECTIUNEA B - B
scara 1:10

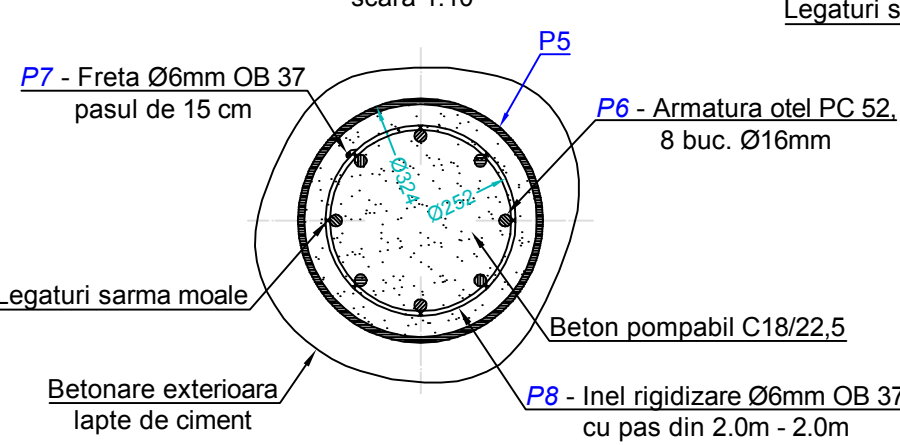

VEDERE LATERALA C
scara 1:10

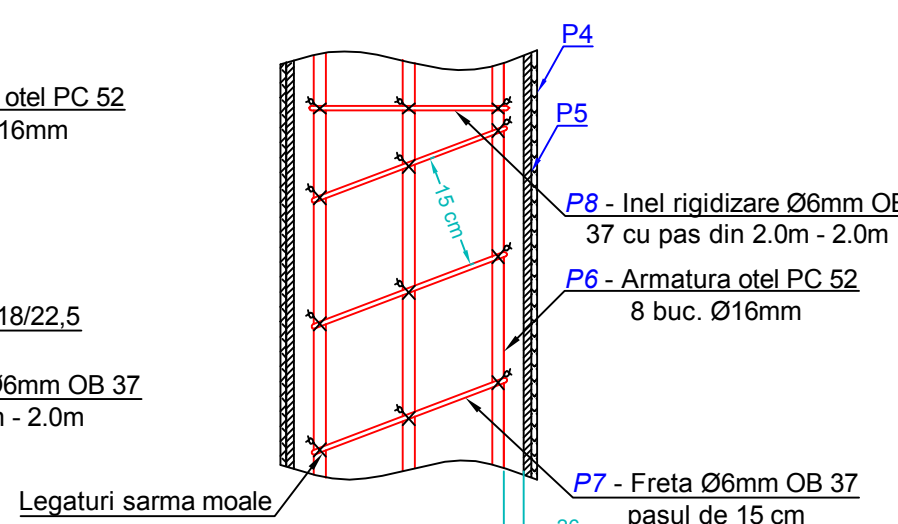

P8 - Inel rigidizare - Ø6,
OB 37, L= 0.86 m

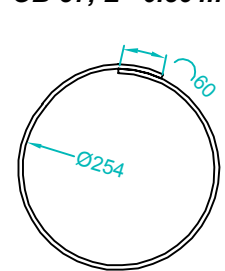

P2 - 8mm
scara 1:10

